

## Company profile

Zhangjiagang comark Machinery Co., LTD. is located in jingfeng Town, Zhangjiagang City, Jiangsu Province. It has international standard workshop more than 10000 square meters. It is one of the professional beverage packaging machinery manufacturers with collecting research, development and manufacturing. It is China's best beverage machinery equipment suppliers. As liquid packaging industry enterprise, the drink service network is all over the world more than 30 countries and regions, products are widely used in drinks, flavor, cosmetic, beer, milk, and pharmaceutical industries. Since company has begun, focused on the professional technology --- beverage packaging machinery, to forge leading beverage packaging machinery, upstream and downstream related both beverage packaging equipment research and development. Always adhere to technological innovation to drive the company development. It has been applied for patents, has formed a unique market with competitive advantage. In order to make our equipment performance better and more stable of operation, our company cooperates with domestic professional institutes, colleges and universities to carry out the combination of the filling machine and optimized the related equipment design, especially with Shanghai jiaotong university school of mechanical engineering. Using Shanghai jiaotong university, wuxi institute of food engineering technology and other universities' strong technology research and development strength, to analyze the foreign advanced technology, digestion on the basis of absorbing foreign advanced technology, to change our original design perfectly, and achieved good results.



## Contents



PET Bottle 塑料瓶



Glass Bottle 玻璃瓶



Barrel 大桶

|       |  |
|-------|--|
| 01-02 | CGF Series   |
| 03    | DCGF Series  |
| 04    | QHS Series   |
| 05    | RCGF Series  |
| 06    | RCGGF Series Big Size Pieces 4-in-1<br>Rinsing-Filling Capping Mono-block                          |
| 07    | FCGF Series  |
| 08    | Automatic  |
| 09-10 | QGF 3-5 Gallon Bottle Filling Line   |
| 11    | 3-5L Bottle  |
| 12    | Washing, Filling and Sealing   |
| 13    | LP Series  |
| 14    | POP CANS DRINKS PRODUCTION LINE<br>CANS DEPALLETIZER   |
| 15    | Code Printer<br>Sleeve   |
| 16    | Automatic  |
| 17    | DP Series<br>Bottle Cooler & Warmer  |
| 18    | High Speed Auto Shrink Packing Machine   |
| 19-21 | Automatic PET Bottle Blowing Machine   |
| 22    | Semi-automatic Bottle Blowing Machine  |
| 23    | Semi-automatic<br>Plate Sterilizer<br>ZR Series<br>LY Series                                       |
| 24    | Automatic<br>Pate Type Automatic   |
| 25    | Automatic<br>Semi-Automatic<br>Power Automatic   |
| 26    | SJY-1000A/B/C Series   |
| 27    | Water Treatment System   |
| 28    | Pre-Processing system<br>Conveyor System   |
| 29    | Air Conveyor System<br>Carbon Dioxide Filter<br>Syrup Cooler<br>Sugar Melting Pot<br>Blending Tank |
| 30    | Vacuum Degasser Machine<br>Ultra High<br>High Pressure Homogenizer                                 |
| 31-32 | Pure Water Filling Production Line   |
| 33-34 | CARBONATED DRINK PRODUCTION LINE   |
| 35-36 | JUICE/TEA HOT FILLING PRODUCTION LINE  |

## CGF Series

### Water Filling 3-in-1 Machine



The machine is mainly used for washing, filling, sealing non-carbonated drink such as mineral water, pure water and so on. The machine shorten the contact time of the drink material and outside, increasing the sanitation condition, productivity and economy benefit.

#### ■ Characteristics

The suspending bottle-neck conveyor structure makes the bottles stably during the high-speed moving conditions, and make changing bottle model more conveniently. Human-machine interface touch-screen and PLC program make it a high degree of automatic production. All parts that have directly contact with the water are made of high quality stainless steel. The main electrical components are from international famous companies, such as Mitsubishi, Schneider, Omron.



#### ■ Main Technological Parameter

| Model                 | CGF 14-12-5            | CGF 18-18-6    | CGF 24-24-8    | CGF 32-32-10   | CGF 40-40-12   | CGF 50-50-15   | CGF 60-60-15   |
|-----------------------|------------------------|----------------|----------------|----------------|----------------|----------------|----------------|
| Capacity(500ml/bph)   | 3000-4000              | 4000-6000      | 8000-10000     | 12000-14000    | 16000-18000    | 20000-24000    | 25000-28000    |
| Suitable Bottle Shape | PET Circular or Square |                |                |                |                |                |                |
| Bottle Diameter(mm)   | Φ50-Φ115               |                |                |                |                |                |                |
| Bottle Height(mm)     | 150-320                |                |                |                |                |                |                |
| CAP                   | Plastic Screw Cap      |                |                |                |                |                |                |
| Power(km)             | 4.23                   | 5.03           | 6.57           | 8.63           | 10.68          | 12             | 13             |
| Size(mm)              | 2230*1630*2250         | 2360*1830*2250 | 2900*2200*2250 | 3880*2200*2250 | 3700*3000*2350 | 4500*3300*2350 | 5500*4000*2450 |
| Weight(kg)            | 2200                   | 2500           | 4200           | 6000           | 7000           | 9000           | 11000          |

## DCGF Series

Carbonated Drink 3-in-1 Filling Machine



### ■ Usage and Characteristics

The series equipment is used to fill all kinds of carbonated drinks contained in PET bottle. It realize washing, filling and capping in one machine with complete automation, and is suitable for all kinds of bottles. The bottleneck blocking makes the process of changing bottles easy by only adjusting the height of conveyor chain. The filling process adopts the micro-pressure technology, which makes filling process faster and more stable. The main machine adopts advanced PLC control, and the key electric elements are from famous international brand. The equipment is designed scientific and reasonable with high production and quality.

### ■ Main Technological Parameter

| Model                    | DCGF 14-12-5                                | DCGF 18-18-6   | DCGF 24-24-8   | DCGF 32-32-10  | DCGF 40-40-12  | DCGF F50-50-12 | DCGF 60-60-15  |
|--------------------------|---|----------------|----------------|----------------|----------------|----------------|----------------|
| Capacity(500ml/bottle/h) | 2000-3000                                   | 3000-5000      | 5000-7000      | 7000-10000     | 10000-15000    | 16000-20000    | 20000-24000    |
| Filling precision        | ≤+5 (liquid level)                          |                |                |                |                |                |                |
| Filling pressure         | ≤0.4Mpa                                     |                |                |                |                |                |                |
| Bottle height            | 160-320mm                                   |                |                |                |                |                |                |
| PET bottle specification | Bottle diameter 50-115mm , Height 160-320mm |                |                |                |                |                |                |
| Suitable cap shape       | Plastic screw cap or crown cap              |                |                |                |                |                |                |
| Total power              | 4.4   | 5.2            | 6.2            | 6.2            | 7.5            | 11             | 15             |
| Overall dimensions       | 2250×1650×2250                              | 2600×1965×2200 | 2980×2200×2250 | 3880×2200×2250 | 4000×2250×2500 | 5500×3500×2500 | 6500×5500×2550 |
| Weight(kg)               | 2500  | 3500           | 4500           | 6000           | 7200           | 8500           | 9500           |

## QHS Series

Drink Mixer



### ■ Usage and Characteristics

QHS series drink mixer is designed and made for improving the proportion of water , syrup and carbon dioxide. It adopts foreign advanced technology static mixer to lighten water layer, increase carbonizing time, ensure mixing efficiency. Adopt carbon dioxide backflow deoxidization , which can save carbon dioxide and deoxidize. High quality water pump and SEIMENS electrical equipment and other parts make up a complete automatic control system. It has coordinating action, beautiful appearance, convenient washing, high automatic level and other advantages. It is suitable for mixing all kinds of drinks, such as soda water, fruit juice, cola and other soft and hard drinks.

### ■ Main Technological Parameter

| Model  | QHS-1500     | QHS-3000       | QHS-4000       | QHS-5000       | QHS-6000       |
|--|--------------|----------------|----------------|----------------|----------------|
| Production Capacity(kg/h)                          | 1000-1500    | 3000           | 4000           | 5000           | 6000           |
| Adjust Proportion of Syrup and Water               | 1:3-1:10     |                |                |                |                |
| Gaseous Quantity                                   | 1.5-2.5      | >2.5           | >2.5           | >2.5           | >2.5           |
| Cool Water Entry Temperature(°c)                   | 0-5          |                |                |                |                |
| Working Pressure of Carbonized and Syrup Tank(Mpa) | 0.05-0.15    |                |                |                |                |
| Storage Tank Working Pressure(Mpa)                 | 0.2-0.5      |                |                |                |                |
| Power(kw)  | 1.5          | 3.7            | 4.05           | 5.6            | 6.2            |
| Dimension(mm)                                      | 900×700×2000 | 1720×1140×2100 | 1860×1300×2100 | 1960×1400×2150 | 2020×1500×2200 |
| Weight(kg)   | 500          | 1100           | 1300           | 1660           | 1800           |

## RCGF Series

Juice Hot Filling 3-in-1 Machine



### ■ Usage and Characteristics

The series equipment is used in hot filling and sealing of tea, fruit juice drink and etc. The machine integrates washing, filling and capping together. It is good equipment for hot filling with scientific and reasonable design and easy operation.

The machine adopts bottleneck blocking and filling valve rise-drop design, and it satisfies for 95 ℃ hereinafter hot filling technology demand. The function of fluent and fast filling action, high filling precision, reliable capping and low material loss makes it effectively prevent secondary pollution of the neck. It can achieve the replacement of different bottles only by exchanging equivalent parts.

It adopts person-machine interface touch screen, PLC, transducer etc advanced control technology with high automation in the whole process. The machine main electrical parts are from famous international manufacturer.

### ■ Main Technological Parameter

| Model                          | RCGF<br>14-12-5                                | RCGF<br>18-16-6 | RCGF<br>24-24-8 | RCGF<br>32-32-10 | RCGF<br>40-40-12 |
|--------------------------------|--|-----------------|-----------------|------------------|------------------|
| Production Capacity:500ml(b/h) | 3000-4000                                      | 4000-6000       | 8000-10000      | 10000-12000      | 12000-15000      |
| Filling precision              | ≤5mm (liquid level)                            |                 |                 |                  |                  |
| Filling pressure(Mpa)          | ≤10%   |                 |                 |                  |                  |
| Suitable bottle standard:(mm)  | Bottle diameter:φ50-92 bottle height:150-310mm |                 |                 |                  |                  |
| Suitable cap standard:(mm)     | Plastic screw cap                              |                 |                 |                  |                  |
| Total power(kw)                | 5.88   | 6.88            | 7.68            | 9.18             | 11.28            |
| Overall Dimension(L*W*H,mm)    | 2100×1500×2200                                 | 2450×1800×2200  | 2750×2180×2200  | 3800×2200×3150   | 4500×3400×3150   |
| Total Weight:(kg)              | 2500   | 3000            | 4000            | 5000             | 6000             |

## RCGGF Series Big Size Pieces(Paste,Oil etc.)4-in-1 Rinsing-Filling(Filling)-Capping Mono-block

This Machine is composed of Rinsing-(Big Size)Fruit Pulp Filling-Juice Filling-Capp;The Pulp filling system adopts piston technology,So the machine is suitable for bigger size fruit pulp filling,we also have technology for normal size fruit pulp juice filling by 3-in-1 Mono-block machine.



### ■ Main Technological Parameter

| Model                           | RCGGF<br>18-12-16-5 | RCGGF<br>24-16-24-8 | RCGGF<br>32-18-32-8 | RCGGF<br>40-24-40-10 | RCGGF<br>50-32-50-12 |
|---------------------------------|---------------------|---------------------|---------------------|----------------------|----------------------|
| Production Capacity(500ml)(b/h) | 5000-6000           | 8000-10000          | 10000-12000         | 15000-16000          | 18000-20000          |
| Total Power(kw)                 | 7.68                | 8.68                | 10.18               | 12.28                | 13.28                |



## FCGF Series

Wine, Vodka, Whiskey, Glass Bottle Filling 3-in-1 Machine

### ■ Technical Characteristics

Filling valve adopts high precision mechanical filling valve, with the character of no bottle no vacuum pumping. Open gear combined gear box transmission, with on-off device. Frequency conversion velocity modulation device extends the speed modulation scope.

This machine has self oil lubrication device so that the lubrication points could be lubricated regularly in time. The machine is of high efficiency, low noise and long life.

Centering guide is of double guide bar type, with the function of pre-covering.

Some of the machine parts can be adjusted to fit different sizes of bottles.

The material height in the bottle is controlled by electric probe to assure the precise liquid level.



### ■ Main Technological Parameter

| Model                      | BGF12/6          | BGF18/6          | BGF24/6          | BGF32/6          |
|----------------------------|------------------|------------------|------------------|------------------|
| Production Capacity(500ml) | 1000-1200B/H     | 2000-3000B/H     | 4000-5000B/H     | 6000-8000B/H     |
| Total power                | 1.5kw            | 2.4kw            | 3.75kw           | 5.6kw            |
| Weight                     | 2000kg           | 2400kg           | 3000kg           | 3500kg           |
| Overall dimension          | 1700×1100×2300mm | 1830×1320×2300mm | 1950×1580×2500mm | 2100×1850×2500mm |

## Automatic

Oil Filling Machiner

### ■ Usage and Characteristics

This type machine is suitable for filling viscous, inviscid and corrosive liquid. It's widely applied in plant oil, chemical liquid and daily industry.

This series includes rotation and linear two types, which can be chosen by customs. Filling capacity can be adjusted from 250ml to 2000ml.

Protection device for overload clutch is set at the thumb wheel of bottle input and output. It will automatically stop and alarm if abnormal case happens.

With liquid crystal display, and quantify accurately. Vacuum anti-dropping device ensures no leaking situation in production.

It is simple and rapid for changing the varieties with unique design and superior capability. It is a set of high



### ■ Main Technological Parameter

| Model             | PF-R8-4                    | PF-R12-5 | PF-R18-6 | PF-R24-8 | PF-R32-10 |
|-------------------|----------------------------|----------|----------|----------|-----------|
| Filling Heads     | 8                          | 12       | 18       | 24       | 32        |
| Capping Heads     | 4                          | 5        | 6        | 8        | 10        |
| Filling Volume    | 200ml-1000ml, 500ml-2000ml |          |          |          |           |
| Capacity (B/H)    | 2800                       | 3500     | 7000     | 10000    | 16000     |
| Filling Tolerance | ≤4%                        |          |          |          |           |

## QGF 3-5 Gallon Bottle Filling Line



BS-1 Pull Lid And Scrub Barrel Machine



This filling line specially produce 5 gallons barreled drinking water,those types(barrels/hour) are:100 type.150 type.200 type.300 type.450 type.600 type.1200 type.It integrates bottle washer,filler and seater into one unit.in order to achieve the purpose of multiple injections of washing and sterilizing by means of liquid washing and bleaching are used in bottle washer,washing solution can be used circularly.The seater can seal barral caps automatically.This line equips with water spraying device to sterilize capes of bottles in order to ensure those caps are aseptic and healthy,also this line can automatically carry out barrel feeding,washing,sterilizing,filling,capping,counting and products discharging.It is a nes king of barreled wster auto-producing line. Which integrates mechanism,electricity and pneumatics technoiogies together.



QGF-300



QGF-400



| Model           | QGF-100   | QGF-240   | QGF-300   | QGF-450   | QGF-600   | QGF-900   | QGF-1200  | QGF-1500  | QGF-2000  |
|-----------------|-----------|-----------|-----------|-----------|-----------|-----------|-----------|-----------|-----------|
| Filling Heads   | 1         | 2         | 2         | 3         | 4         | 5         | 7         | 8         | 10        |
| Volume          | 18.9      | 18.9      | 18.9      | 18.9      | 18.9      | 18.9      | 18.9      | 18.9      | 18.9      |
| Barrel size     | ø270×490  | ø270×490  | ø270×490  | ø270×490  | ø270×490  | ø270×490  | ø270×490  | ø270×490  | ø270×490  |
| Capacity        | 600-100   | 100-240   | 250-300   | 450       | 600       | 900       | 1200      | 1500      | 2000      |
| Gas pressure    | 0.4-0.6   | 0.4-0.6   | 0.4-0.6   | 0.4-0.6   | 0.6       | 0.6       | 0.6       | 0.6       | 0.6       |
| Gas consumption | 0.37      | 0.37      | 0.6       | 0.8       | 1         | 1.5       | 1.5       | 1.5       | 1.5       |
| Motor power     | 1.38      | 1.75      | 3.8       | 3.8       | 7.5       | 9.75      | 13.5      | 13.5      | 13.5      |
| Rated Voltage   | 380V/50HZ | 380V/50HZ | 380V/50HZ | 380V/50HZ | 380V/50HZ | 380V/50HZ | 380V/50HZ | 380V/50HZ | 380V/50HZ |
| Weight          | 680       | 800       | 1500      | 2100      | 2500      | 2800      | 3500      | 3800      | 3900      |

## 3-5L Bottle Water Filling Line



The equipment is used in production of non-carbonated drink of minerals and pure water packed in polyester bottles-3L,4L and 5L. It mixed washing,filling and capping in one machine. The whole machine have scientific and reasonable design, beautiful appearance, complete functions, easy operation and maintenance, a high degree of automation. The filling is fast, the amount of liquid is accurately controlled. It adopts the chain channel to deliver, wash, fill and seal the bottles. You could replace the bottles freely by changing the dial guide plate, as long as that the dimensions of sealing surface, bottleneck and cap are the consistent. The magnetic torque is used for screw capping to achieve grab and screw caps.

The power of screw capping can be adjusted without steps. The power of the screw capping can also be fixed, and the caps will not be damaged, the capping is reliable. The horizontal rotary pneumatic cap sorter with no damage to the surface of the caps, and it could supply the caps in the hopper automatically. The whole machine is controlled by PLC with touch-screen as the human-machine interface.The amount of the drinks in the storage tank can be controlled automatically. The filling and capping will be stopped automatically when there is no bottle. When bottles are cramped wrongly or when caps are not available, the machine can be stopped automatically.

### ■ Main Technological Parameter

| Model                          | SGF-12-12-5    | SGF-16-16-5    | SGF-24-24-8    |
|--------------------------------|----------------|----------------|----------------|
| Production Capacity(b/h)       | 1200-1500      | 1500-2000      | 3000-4000      |
| Filling Volume(L)              | 2.5-5          | 2.5-5          | 2.5-5          |
| Rinser-Filler-Capper Quantity  | 12-12-5        | 16-16-5        | 24-24-8        |
| Filling Accuracy(%)            | ±2             | ±2             | ±2             |
| Pneumatic Pressure(Mpa)        | 0.7            | 0.7            | 0.7            |
| Air Consumption(L/min)         | 800            | 800            | 800            |
| Pressure Washing(Mpa)          | 0.2-0.25       | 0.2-0.25       | 0.2-0.25       |
| Rinsing Water Consumption(L/h) | 1.8            | 2.4            | 2.4            |
| Rated Voltage(V)               | 380            | 380            | 380            |
| Total Power(kW)                | 2.2            | 2.2            | 2.8            |
| Motor Power(kW)                | 3.5            | 3.5            | 4.0            |
| Dimensions(L*W*H)(mm)          | 3000*2000*2500 | 3350*2500*2500 | 3690*2790*2500 |
| Weight(kg)                     | 4000           | 5000           | 5000           |

## Washing, Filling and Sealing

Production Line for Pure Water, Mineral Water, Fruit Juice, Wine, etc



### ■ Application:

This series machine applies for washing, filling and capping all kinds of plastic and glass bottles. The line is widely used in filling all kinds of non-carbonated drinks, such as mineral water, pure water, tea, juice and other liquid.



### ■ Characteristics:

The key parts for washing, filling and sealing are made of high quality stainless steel, with the features of advanced technology, complete system, easy operation. This line is the ideal equipment for the small and medium factories.

### ■ Main Technological Parameter

| Model                 | QS-12,GD-12,<br>YQX-1                           | QS-18,GD-18,<br>YQX-3                            | QS-24,GD-24,<br>YQS-6                             |
|-----------------------|---|--|---|
| Capacity(bottle/hour) | 2000  | 4000   | 6000  |
| Total Power(KW)       | 3.13  | 4.45   | 5.25  |
| Overall Size(mm)      | 1100*1100*1800<br>1000*900*2000<br>900*700*2200 | 1100*1100*1800<br>1000*900*2000<br>1000*900*2200 | 1500*1500*2000<br>1500*1500*2000<br>1000*900*2200 |

## LP Series

### Bottle Unscrambler



The machine is used for ordering disordered polyester bottles. The disordered bottles are carried into the storing bottle section by elevator. With the help of the pushing force of the rotating disk, the bottles enter their position. With the function of the turning bottle device and the air-flow, the bottles are ordered into bottle mouth-up-position and are carried into the next process with the air-transferring type conveying bottle system.

The machine adopts PLC computer control, frequency control to adjust its production capacity. It has a screener to automatically remove non-standard bottles.

#### ■ Main Technological Parameter

| Model                                | LP-1  | LP-2           | LP-3           |
|--------------------------------------|---|----------------|----------------|
| Diameter(mm)                         | 2450  | 2600           | 3000           |
| Production capacity(bph)             | 8000-10000                                    | 12000-15000    | 18000-24000    |
| Suitable bottle type(mm)             | Bottle diameter:Φ50-Φ90 bottle height:150-290 |                |                |
| Gas source pressure(Mpa)             | 0.7   | 0.7            | 0.7            |
| Gas consumption(m <sup>3</sup> /min) | 0.4   | 0.6            | 0.8            |
| Main motor power(kw)                 | 1.5   | 2.2            | 4              |
| Weight(kg)                           | 3000  | 4000           | 6000           |
| Overall dimension(mm)                | 3100×2450×2200                                | 3300×2600×2200 | 3700×3000×2200 |

## POP CANS DRINKS PRODUCTION LINE

### (NON-CARBONATED/CARBONATED/VEGETABLE PROTEIN/TEA)

This kind of production line is mainly used for washing filling and capping for pop-top cans, which are made of tinplate, aluminum and PET material. It has functions of lifting the cans automatically, reverse automatically washing filling and capping. It can reach the big capacity. It is the ideal machines for producing the carbonated drink, like COKE COLA, PEP. SI COLA.

#### ■ Main Technological Parameter

| Model                      | GF12-4           | GF18-4           | GF24-6A          | GF36-6           | GF48-8           |
|----------------------------|------------------|------------------|------------------|------------------|------------------|
| The number of capping head | 4                | 4                | 6                | 6                | 8                |
| The number of filling head | 12               | 18               | 24               | 36               | 48               |
| Production capacity        | 30-170cans/min   | 30-250cans/min   | 30-300cans/min   | 80-400cans/min   | 80-600cans/min   |
| Can diameter               | Φ 52.5-99mm      | Φ 52.5-99mm      | Φ 52.5-85.5mm    | Φ 52.5-99mm      | Φ 52.5-72.9mm    |
| Can height                 | 39-160mm         | 39-160mm         | 39-160mm         | 39-160mm         | 39-160mm         |
| Power                      | 5.5KM            | 5.5KM            | 7.5KM            | 7.5KM            | 11KM             |
| Weight                     | 3100Kg           | 3800Kg           | 4400Kg           | 5000Kg           | 7750Kg           |
| Dimension                  | 2700×1400×1900mm | 3050×1750×1900mm | 2875×1775×1900mm | 3660×2530×1900mm | 3650×2530×2100mm |



#### CANS DEPALLETER

TXD-150 empty cans unloading stacking machine is mainly used in unloading operation of tin cans and aluminum cans, to make the empty can stacked on pallets to the mesh conveyor under a layer of a layer by pushed. Then transport to empty cans spray washer by the conveyor to replace labor and save manpower.

#### ■ Main Technological Parameter

| Model                  | Xc400            |
|------------------------|------------------|
| Production capacity    | 30-400cans/min   |
| Applicable tank height | 39-168mm         |
| Tank diameter          | Φ52.2-99mm       |
| Power(kw)              | 2.5km            |
| Weight                 | 2500kg           |
| Dimension              | 7500×2100×3150mm |



## Code Printer



The equipment adopts international advanced septal inner pump technology with ink pump, solvent pump, back pump and cycling pump together. It is of high automation and can print production date and bar code.



## Sleeve Label Machine



### ■ Main Technological Parameter

This machine adopts international advanced technology: cover the circle label on the pet bottle. And then hot shrinking to fix on the position which bottle body designated. It is controlled by micro-computer; automatic detection and position.

This machine's structure is compact, and suitable for the production line of different direction and different height.

The machinery part adopts combination designing of modularization, and makes the machine reasonable. The height adjustment adopts motor fluctuating; it is convenient to replace the material. The special cutter head designing make the film-rolling cut more exactly.

| Model                    | SL-150        | SL-250        | SL-300         | SL-400         |
|--------------------------|---------------|---------------|----------------|----------------|
| Production capacity      | 100-150B/Min  | 250B/Min      | 300B/Min       | 400B/Min       |
| Suitable bottle diameter | Φ28-Φ125mm    |               |                |                |
| Suitable label material  | PVC PET OPS   |               |                |                |
| Label thickness          | 0.03mm-0.13mm |               |                |                |
| Weight                   | 450Kg         | 550Kg         | 600Kg          | 700Kg          |
| Overall dimension        | 2100x850x2000 | 2100x850x2000 | 2100x1100x2000 | 2500x1200x2200 |

## Automatic Film Shrink Wrapping Machine



### ■ Characteristic:

With full automatic functions of bottle transfer and arrange, membrane packing, sealing and cut, shrinkage, cooling and shaping, etc.

Adopt with PLC automatic program circulation control with stable and reliable performance. 3 layers of heat insulation treatment with good insulating property, quick temperature rise and energy saving.

The enhanced cooling shaping passage can quickly turn the packing membrane into high strength status that is conveniently stored and transported.

It is easy to change the packaging combination and bottle type to integrate the multi-function into one machine.

### ■ Specification:

Dimension for the whole unit: L6000mm × W3270mm × H2100mm  
 Thermal shrinkage passage dimension: L1800mm × W650mm × H450mm  
 Max. package dimension: L600mm × W400mm × H350mm  
 Transfer belt dimension: 800-1200mm  
 Packaging speed: 8-10Pgs/minute  
 Operating power supply/power: 380v 19kw  
 Sealing and cut time/temperature: 0.6-1.5s 160℃-180℃  
 Operating air pressure: 0.6-0.8Mpa  
 Air consumption: 0.3m<sup>3</sup>/minute

## DP Series

Bottle Inverse Sterilizer Machine



### ■ Usage and Characteristics

It is mainly used in sterilizing PET bottle mouths and inside surface of caps which haven't been disinfected after filling thermal tea or fruit juice in PET bottles. It mainly consists chief conveying system, bottle reserving chain system, support, bottle reserving guiding and repositioning rod. It uses its inner thermal medium to disinfect bottle mouths and caps without any other heat source to save energy.



## Bottle Cooler & Warmer



### ■ Usage and Characteristics



Based on advanced technologies from Germany, Italy and Taiwan, we developed this new type of bottle cooling/warming machine. Its working process can be divided into 3 stages, circulating hot water spraying, warm water pre-cooling and cold water cooling. The temperature and time can be setting according to the requirements of user. The machine is suitable for all kinds of bottled or canned beverage, also is used for warming carbonated beverage and cooling hot beverage. It has advantages of supermatic program control, easy and reliable operation and nice appearance, which is an ideal sterilization equipment.

## High Speed Auto Shrink Packing Machine

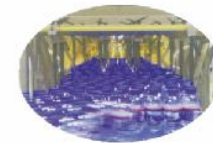

### ■ Characteristic:

Specially designed and manufactured for the high-speed packing requirements of drinks (pure water, beverage, fruit juice and milk product). During the product forward conveying process, it can automatically group the product into package, so as to save time and enhance packing efficiency. Touch screen operating panel with user-friendly interface and convenient parameter setup, absolutely an easy-to-operate machine. The ideal model of middle-speed heat-shrinking packager is the first choice in the market.

### ■ Technical Parameter:

Dimension for the whole unit: L11450mm × W1100mm × H2100mm  
 Thermal shrinkage passage dimension: L2400mm × W650mm × H450mm  
 Max. package dimension: L600mm × W400mm × H350mm  
 Transfer belt dimension: 650mm  
 Packaging speed: 15-20Psc/min  
 Operating power supply/power: 380v 35kw  
 Sealing and cut time/temperature: 0.5-1s 180℃-210℃  
 Operating air pressure: 0.6-0.8Mpa  
 Air consumption: 100NL/min

## Automatic PET Bottle Blowing Machine



### ■ Main Technological Parameter

YCQ series fully automatic machine is developed by advanced bottle blowing technology, it has the advantage of high-level fully automatic, stable working performance, simple structure but high Working efficiency. Also, these model are energy-saving, low noise, prevent production from polluting during the working process. These model widely used in blowing drinking bottle, cosmetics bottle and medical bottle etc. So far Eceng have provided more than 800 blow moulding machine for more than 100 countries in the world. We will always keep researching, supply better service and stable machine to our customer, all what we do is to make sure us and our customer to be the leader of our industry.

### ■ Main Technological Parameter

|                                   | Item                                  | YCQ-2L-2                | YCQ-2L-3                | YCQ-2L-4                |
|-----------------------------------|---------------------------------------|-------------------------|-------------------------|-------------------------|
| Bottle type specification         | Cavity                                | 2                       | 3                       | 4                       |
|                                   | Theory output                         | 2400-2700               | 3500-4000               | 4500-5000               |
|                                   | Max. volume                           | 2L                      | 2L                      | 2L                      |
|                                   | Bottle mouth maximum overall diameter | 80mm                    | 28-38mm                 | 28-38mm                 |
|                                   | Bottle biggest diameter               | 100mm                   | 100mm                   | 100mm                   |
|                                   | Bottle maximum height                 | 330mm                   | 330mm                   | 330mm                   |
|                                   | Power specifications                  | Light tube quantity     | 32pcs                   | 32pcs                   |
| Light tube power                  |                                       | 0.75KW                  | 1.25KW                  | 1.25KW                  |
| Maximum heating power             |                                       | 24KW                    | 40KW                    | 40KW                    |
| All electric machine installation |                                       | 27KW                    | 43KW                    | 43KW                    |
| Actual consumption                |                                       | 8.1KW                   | 21.5KW                  | 21.5KW                  |
| Air pressure specification        | Work pressure                         | 7-9kg/cm <sup>2</sup>   | 7-9kg/cm <sup>2</sup>   | 7-9kg/cm <sup>2</sup>   |
|                                   | Low-pressure gas consumption          | 1000L/min               | 1600L/min               | 1600L/min               |
|                                   | Blow bottle pressure                  | 25-35kg/cm <sup>2</sup> | 25-35kg/cm <sup>2</sup> | 25-35kg/cm <sup>2</sup> |
|                                   | Higher-pressure gas consumption       | 1500Ltr/min             | 2500Ltr/min             | 3000Ltr/min             |
|                                   | Forzen water specification            | Work pressure           | 5-6kg/cm <sup>2</sup>   | 5-6kg/cm <sup>2</sup>   |
| Temperature range                 |                                       | 10℃                     | 10℃                     | 10℃                     |
| Consumption                       |                                       | 5000kcal/hr             | 8000kcal/hr             | 8000kcal/hr             |
| Forzen water flow                 |                                       | 30L/min                 | 88L/min                 | 88L/min                 |
| Machine specification             | Size of the machine                   | 2.25×1.6×1.7            | 4.0×1.6×1.9             | 4.5×1.6×1.9             |
|                                   | Weight of the machine                 | 2.5ton                  | 3ton                    | 3.5ton                  |



### ■ Main Technological Parameter

|                            | Item                                  | YCQ-2L-6                | YCQ-2L-8                | YCQ-10L-1               | YCQ-20L-1               |
|----------------------------|---------------------------------------|-------------------------|-------------------------|-------------------------|-------------------------|
| Bottle type specification  | Cavity                                | 6                       | 8                       | 1                       | 1                       |
|                            | Theory output                         | 6000-8500               | 8000-12000              | 500                     | 300                     |
|                            | Max. volume                           | 2L                      | 2L                      | 10L                     | 20L                     |
|                            | Bottle mouth maximum overall diameter | 28-38mm                 | 28-38mm                 | 150mm                   | 150mm                   |
|                            | Bottle biggest diameter               | 100mm                   | 100mm                   | 240mm                   | 350mm                   |
|                            | Bottle maximum height                 | 330mm                   | 330mm                   | 450mm                   | 550mm                   |
| Power specifications       | Light tube quantity                   | 32pcs                   | 32pcs                   | 48pcs                   | 48pcs                   |
|                            | Light tube power                      | 1.25KW                  | 1.5KW                   | 1.5KW                   | 1.9KW                   |
|                            | Maximum heating power                 | 40KW                    | 54KW                    | 72KW                    | 72KW                    |
|                            | All electric machine installation     | 43KW                    | 57KW                    | 75KW                    | 75KW                    |
|                            | Actual consumption                    | 30.1KW                  | 40KW                    | 37.5KW                  | 52.5KW                  |
| Air pressure specification | Work pressure                         | 7-9kg/cm <sup>2</sup>   | 7-9kg/cm <sup>2</sup>   | 7-9kg/cm <sup>2</sup>   | 7-9kg/cm <sup>2</sup>   |
|                            | Low-pressure gas consumption          | 1600L/min               | 1600L/min               | 1600L/min               | 1600L/min               |
|                            | Blow bottle pressure                  | 25-35kg/cm <sup>2</sup> | 25-35kg/cm <sup>2</sup> | 25-35kg/cm <sup>2</sup> | 25-35kg/cm <sup>2</sup> |
|                            | Higher-pressure gas consumption       | 4000Ltr/min             | 4800Ltr/min             | 2000-3000Ltr/min        | 2000-3000Ltr/min        |
| Forzen water specification | Work pressure                         | 5-6kg/cm <sup>2</sup>   | 5-6kg/cm <sup>2</sup>   | 5-6kg/cm <sup>2</sup>   | 5-6kg/cm <sup>2</sup>   |
|                            | Temperature range                     | 10℃                     | 10℃                     | 10℃                     | 10℃                     |
|                            | Consumption                           | 8000kcal/hr             | 12000kcal/hr            | 8000kcal/hr             | 12000kcal/hr            |
| Machine specification      | Forzen water flow                     | 88L/min                 | 88L/min                 | 88L/min                 | 88L/min                 |
|                            | Size of the machine                   | 5.3×1.6×1.9             | 8.45×1.6×1.9            | 2.7×1.5×1.7             | 5.2×2.0×2.0             |
|                            | Weight of the machine                 | 4ton                    | 5ton                    | 3.6ton                  | 6ton                    |



#### ■ Main Technological Parameter

YQC 5L series is two step fully automatic blowing machine specially designed for big bottle, this model has the advantage of high-speed, energy-saving as well as versatile. Best choice for blowing oil bottle, water bottle and juice bottle.

#### ■ Main Technological Parameter

|                            | Item                                  | YQC-5L-1                | YQC-5L-2                | YQC-5L-3                | YQC-5L-4                |
|----------------------------|---------------------------------------|-------------------------|-------------------------|-------------------------|-------------------------|
| Bottle type specification  | Cavity                                | 1                       | 2                       | 3                       | 4                       |
|                            | Theory output                         | 700-800                 | 1500                    | 2000-2500               | 3500-4000               |
|                            | Max. volume                           | 5L                      | 5L                      | 5L                      | 5L                      |
|                            | Bottle mouth maximum overall diameter | 150mm                   | 150mm                   | 150mm                   | 150mm                   |
|                            | Bottle biggest diameter               | 180mm                   | 180mm                   | 180mm                   | 180mm                   |
|                            | Bottle maximum height                 | 400mm                   | 400mm                   | 400mm                   | 400mm                   |
| Power specifications       | Light tube quantity                   | 32pcs                   | 32pcs                   | 48pcs                   | 64pcs                   |
|                            | Light tube power                      | 1KW                     | 1.5KW                   | 1.5KW                   | 1.5KW                   |
|                            | Maximum heating power                 | 32KW                    | 48KW                    | 72KW                    | 96KW                    |
|                            | All electric machine installation     | 35KW                    | 51KW                    | 80KW                    | 130KW                   |
|                            | Actual consumption                    | 24.5KW                  | 35.7KW                  | 50KW                    | 90KW                    |
| Air pressure specification | Work pressure                         | 7-9kg/cm <sup>2</sup>   | 7-9kg/cm <sup>2</sup>   | 7-9kg/cm <sup>2</sup>   | 7-9kg/cm <sup>2</sup>   |
|                            | Low-pressure gas consumption          | 1200L/min               | 1600L/min               | 1600L/min               | 1600L/min               |
|                            | Blow bottle pressure                  | 25-35kg/cm <sup>2</sup> | 25-35kg/cm <sup>2</sup> | 25-35kg/cm <sup>2</sup> | 25-35kg/cm <sup>2</sup> |
|                            | Higher-pressure gas consumption       | 4000Ltr/min             | 3400Ltr/min             | 4000Ltr/min             | 4000Ltr/min             |
| Forzen water specification | Work pressure                         | 5-6kg/cm <sup>2</sup>   | 5-6kg/cm <sup>2</sup>   | 5-6kg/cm <sup>2</sup>   | 5-6kg/cm <sup>2</sup>   |
|                            | Temperature range                     | 10℃                     | 10℃                     | 10℃                     | 10℃                     |
|                            | Consumption                           | 4000kcal/hr             | 6000kcal/hr             | 8000kcal/hr             | 8000kcal/hr             |
|                            | Forzen water flow                     | 30L/min                 | 50L/min                 | 88L/min                 | 100L/min                |
| Machine specification      | Size of the machine                   | 2.4×1.5×1.7             | 4.7×1.6×1.9             | 5.8×1.6×1.9             | 6.2×1.9×2.2             |
|                            | Weight of the machine                 | 2ton                    | 3ton                    | 5ton                    | 5.5ton                  |

## Semi-automatic Bottle Blowing Machine

#### ■ Usage and Characteristics

Semi-automatic bottle blowing machine can blow plastic bottles for water, oil, juice, carbonated drinks and etc. One drying tunnel is matched with two blowers, which is small in size, productive and energy-saving, and fit to blow plastic bottles of various raw material in a big quantity.



#### ■ Main Technological Parameter

| ITEM                       | 01              | 01              |
|----------------------------|-----------------|-----------------|
| Volume Of Product          | 0.3-2L          | 0.3-2L          |
| Production Capacity        | 800Pcs / h      | 1600Pcs / h     |
| Neck Size Of Product       | < 75mm          | < 75mm          |
| Blowing Air pressure       | YM-2P-Bs3.0Mpa  | YM-2P-Bs3.0Mpa  |
| Power Of Main Blower       | 0.1kw           | 0.1*2kw         |
| Power Of Preheater         | 16kw            | 16kw            |
| Weight Of Main Blower      | 580kgs          | 580*2kgs        |
| Weight Of Preheater        | 200kgs          | 200kgs          |
| Measurement Of Main Blower | 1640×600×1650mm | 1640×600×1650mm |
| Measurement Of Preheater   | 1800×580×1350mm | 1800×580×1350mm |

## Semi-automatic

### Clean-in-place

The CIP equipment is used to clean at site of material pipe of the industries like milk products, juice, beverage and etc. A centrifugal pump is used in CIP to convey cleaning liquid into material pipe and equipment recipients to force the cleaning liquid to circulate to make cleaning without taking apart pipes or equipment. By this, capacity utilization rate of the machine can be improved and, at the same time, lessen intensity of labor.



## Plate Sterilizer

It is mainly used for heating and sterilizing in juice, tea beverage, fresh milk, alcohol and other heat sensitivity liquid, also keeping warm and cooling, with the sterilization temperature at 85 °C -135 °C.

## ZR Series

### Double Filter

The equipment is used for filtering liquid, such as sugar liquor, fruit juice, beverage and milk. Continuous operation. Easy to replace filtering screen.



## LY Series

### Cold Water Drink Tank and Refrigerator

The machine adopts Freon compressor, using F-12 as refrigerant. Cold drink is made by water tank evaporator, and the machine equipped with pressure relay and temperature regulator. It is the necessary equipment for aerated water and sparkling wine production.



## Automatic

### Self-adhesive Machine

Instructions: It can independent work or connect to the conveyor  
Bottle types: Glass bottle, plastic bottle and so on.  
Circle, square figure or taper.



Alarm function: There is no colorful belt warning label, lack of label, and broken label warning.

Bottle diameter: 10-120mm High 20-300mm  
Label scope: High 15-150mm Length 25-300mm  
Scroll inner diameter: 76mm  
Scroll outer diameter: 300mm(max)  
Labelling speed: 200-400 bottle/minute  
Accuracy error: ±0.5 (Depending on the bottle cone and vertical degree)  
Electric power: 200V 50/60HZ 1.2KW  
Weight: 220kg  
Outer size: 1500 × 800 × 1300mm



## Pate Type Automatic

### Labeling Machine

This is paste type labeling machine. It first takes the resin adhesive by pole and then sticks the label to vacuum belt and puts the label on the bottle. It is easy to change different types and shapes bottles. The operation is clean and clear.



## Automatic oil filling machine

### Usage and Characteristics

This type machine is suitable for filling viscous, inviscid and corrosive liquid. It's widely applied in plant oil, chemical liquid, and daily chemical industry. It adopts linear type filling, electromechanical & instrumental integration controlling. It's simple and rapid for changing the varieties with unique design and superior capability, it's appearance accords with the international machinery concept. Germany SIEMENS PLC and touch screen control make it intelligentize protection function. Vacuum anti-dropping device ensures no leaking situation in production. Electronic adjusting for volume system, frequency control and photoelectric detecting system (Germany TURCK brand) are applied in this machine.



## Semi-Automatic Oil Filling Machine

This type of machine is widely used in filling of viscous liquid such as plant oil, chemicals. Its features are flexible and can be used anywhere. Its design is distinct. It has many advantages. It has applied imported Germany SIEMENS controller. Filling productivity may exceed 6-15 barrels/min.



## Power Automatic Packing Machine

### Product Recommendation

The screw feeding is used with PLC control, featuring accuracy and stability, suitable to the fields of food, pharmacy, pesticide and chemical industry such as condiments, milk powder, medicine powder and a variety of powders from 100-300 grains.



## SJY-1000A/B/C Series Auto Liquid Sealing Machines

### Product Recommendation

This series is widely used in the film packing of milk, soy milk, all kinds of drinks, soy, vinegar, yellow wine etc. All packing procedures: ultraviolet ray sterilization, molding of bags, print of dates, filling with fixed quantity, sealing and cutting and numeration. All components are made of stainless steels and are designed to meet state hygienic standard. A and B model adopt single-layer polyethylene film while C model employ composite films. Among them, B model is twin type designed so it can fill two types of liquid of different colors and flavor in one package; C model are categorized as middle sealing, side sealing and photo-electric detection.



### Main Technological Parameter

| Model                  | SJY-1000A           | SJY-1000B           | SJY-1000C           |
|------------------------|---------------------|---------------------|---------------------|
| Speeding of Production | 1500-2100bags/hour  | 1500bags/hour       | 1000-1800bags/hour  |
| Packing Capacity       | 100-500ml           | 100-500ml           | 100-1000ml          |
| Packing Size           | L30-150*W120-160mm  | L30-190*W84-120mm   | L30-240*W120-160mm  |
| Power of Machine       | 1.2Kw 220VAC/380VAG | 1.2Kw 220VAC/380VAG | 1.2Kw 220VAC/380VAG |
| Weight of Machine      | 270kg               | 320kg               | 330kg               |
| Overall Dimensions     | 850*800*1800mm      | 950*850*1900mm      | 1050*850*1850mm     |

## Water

### Treatment System



According to customers requirements and the source water quality, we adopt different equipment to produce pure water, mineral water, etc. The main equipments are silica sand filter, active carbon filter, sodium ion exchanger, hollow fiber filter, RO(reverse osmosis), UV sterilizer, precision filter, ozone generator, water tank, etc. The treatment capacity is 0.5-50ton/h. It can effectively get rid of muddy organic matter, iron, manganese and oxide, filter suspended substance, colloid, microorganism, chloride and heavy metal ions in the water, reduce the hardness of the water to make all specifications of the water quality fully meet the state fresh water standard of fresh drink water.



#### ■ Reverse Osmosis Device

The reverse osmosis device is an equipment to purify the saline water with the action of pressure difference of semi-permeable membrane. Water pump-core of the equipment is imported, and the seep film is imported from HAIDENENG CO, in American. It is equipped with a full set of clean unit, it has features of simple structure, convenient operation and high technological level. The quality of the processed water can meet the standard of national drinking water.

## Pre-Processing system

Pre-Processing System is applied to making the juice by washing, squeezing, extracting, mixing, emulsifying, homogenizing, filtering and sterilizing.



## Conveyor System

The conveyor system is applied to deliver the filled bottle. Most of component is made by stamping and bending. So it is stable, efficient and easy maintenance. It also gives the buffering time between each of machines



## Air Conveyor System

The conveyor system is applied to deliver the filled bottle. Most of component is made by stamping and bending. So it is stable, efficient and easy maintenance. It also gives the buffering time between each of machines



## Carbon Dioxide Filter

The equipment is applied to improve purity of CO2 and separate impurity. It mainly used in drinking production industry, also suitable for chemical, foodstuff and wine-making industries. The device is of reasonable design, simple construction, beautiful appearance and strong corrosion-resistance.



## Syrup Cooler



The cooler is the auxiliary equipment for gas water production. It adopts refrigerating compressor using Freon F-12 as refrigerant. It cools syrup to 1-5 through refrigerator with the features of safe and easy operation, stable working process and nice appearance.

## Sugar Melting Pot

It is equipped with heating device, cooling device and agitator, and has the advantage of simple structure and convenient operation. There are two kinds of types, electrical heating and steam heating.



## Blending Tank

It is equipped with heating device, cooling device and agitator, and has the advantage of simple structure and convenient operation. There are two kinds of types, electrical heating and steam heating.



## Vacuum Degasser Machine

The machine is one of the necessary equipments in fruit juice or fruit tea production line. It is mainly used for deaerating the homogenized juice under vacuum condition and to prevent the juice from being oxidized and then to prolong the storing period of the juice.



## Ultra High Temperature(UHT) Instantaneous Sterilizer

The machine is suitable for liquid material, such as fresh milk, fruit drink, wine, soybean milk and Chinese medicine, as well as the sticky material (sweet condensed milk, etc.) upon completing with high pressure homogenizer. It is an ideal sterilization equipment.



## High Pressure Homogenizer

The high pressure homogenizer is a widely used device for homogenizing liquid and material. It is used for ultrafine grinding material, and forming solid and liquid dispersoid, which improves the quality of mixture. The filter is equipped to guarantee the machine operation stable.





**TECHNOLOGICAL FLOW SHEET OF NON-CARBONATED DRINK PRODUCTION LINE**

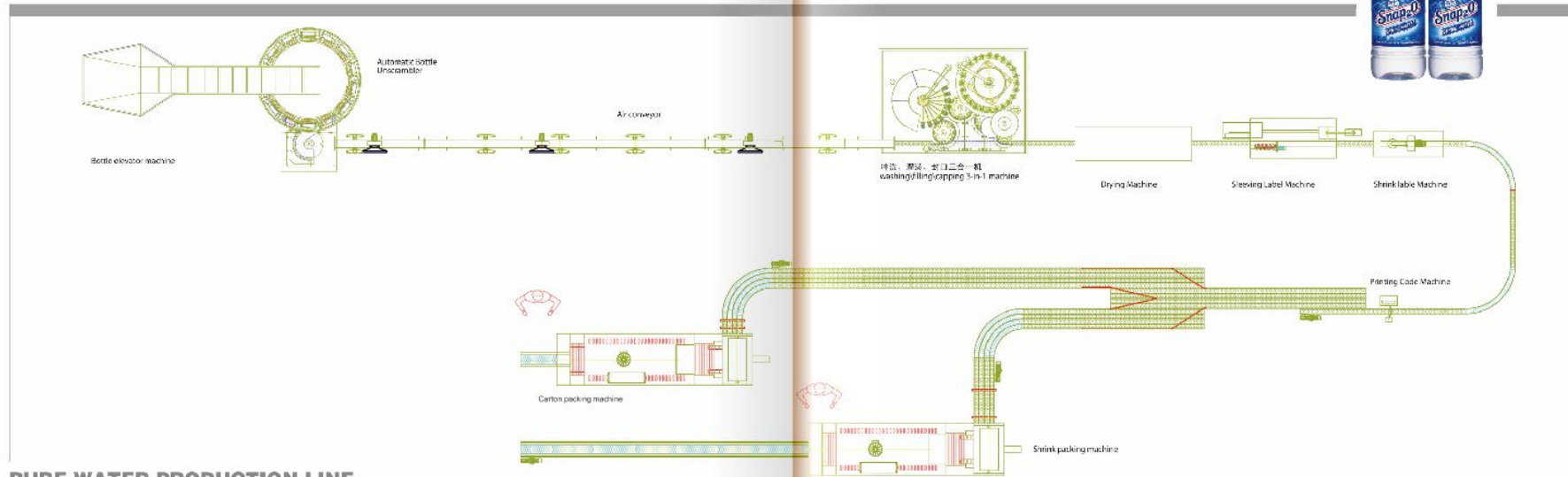

**PURE WATER PRODUCTION LINE AND PRODUCTION TECHNIQUE**

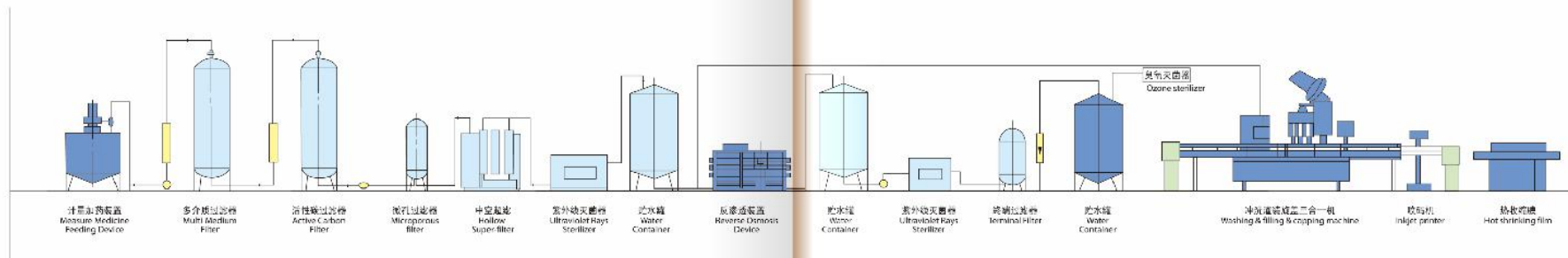

# CARBONATED DRINK PRODUCTION LINE



## TECHNOLOGICAL FLOW SHEET OF CARBONATED DRINK PRODUCTION LINE

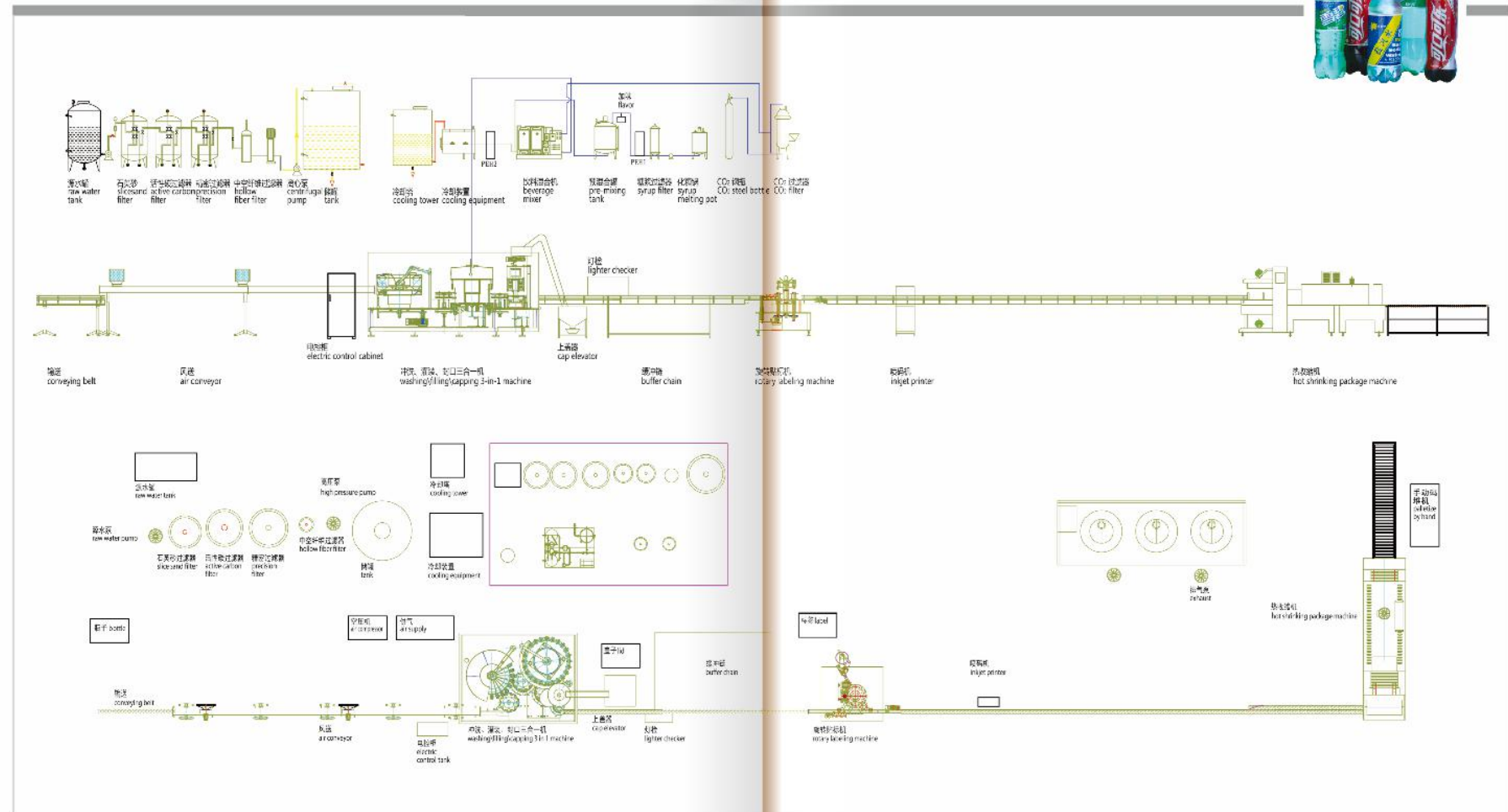

TECHNOLOGICAL FLOW SHEET OF THE HOT FILLING LINE

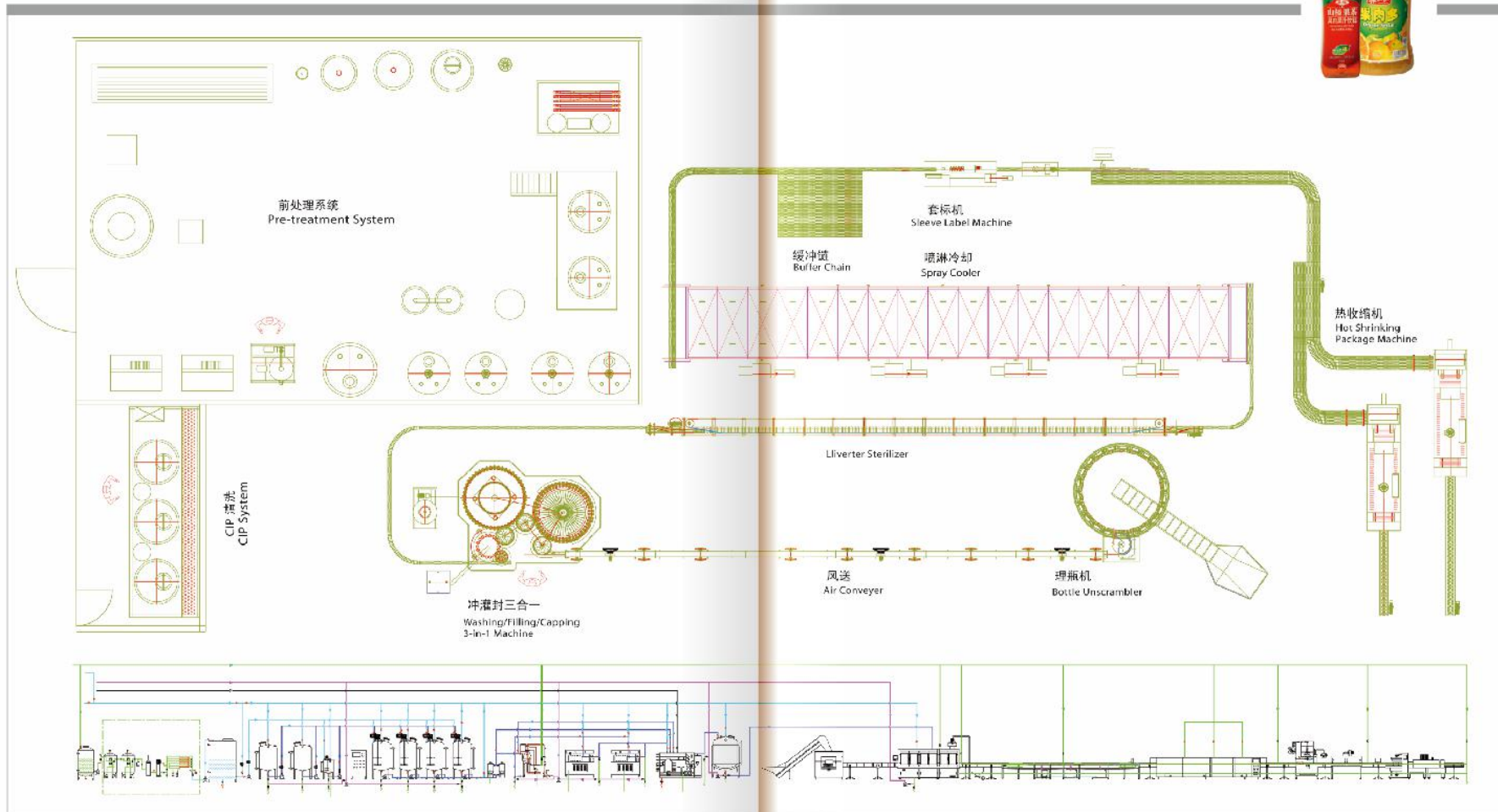



COMARK Machinery  
*Pursues Excellence*

**张家港科玛克机械有限公司**

地址：江苏省张家港市锦丰镇锦绣路212号

传真：+86 0512-55320189

手机：+86 187 5115 4413

QQ：461670602

网址：[www.comarkmachine.com](http://www.comarkmachine.com)

邮箱：[sales@comarkmachine.com](mailto:sales@comarkmachine.com)

邮编：215621

**ZHANGJIAGANG COMARK MACHINERY CO.,LTD**

Add：NO.212 JinXiu Road, JinFeng Town, ZhangJiaGang City, JiangSu Province, China

Fax：+86 0512-55320189

Mob：+86 187 5115 4413

QQ：461670602

Web：[www.comarkmachine.com](http://www.comarkmachine.com)

E-mail：[sales@comarkmachine.com](mailto:sales@comarkmachine.com)

Zip code：215621



Professional  
Beverage machine  
Manufacturer In China



**张家港科玛克机械有限公司**

ZHANGJIAGANG COMARK MACHINERY CO.,LTD